

# Vila Alexandrina

## PROJETO

PARA LOTEAMENTO DE UMA GLEBA DE TERRAS DENOMINADA

VILA ALEXANDRINA  
 PERIENCENTE A DONA  
 ELIZA GUIMARÃES CLARO  
 SITUADA NO DISTRITO DE  
 SANTANA DO PARAIBA  
 DÊSTE MUNICIPIO

AREA = 68.148,61 M<sup>2</sup>

ESCALA = 1:1000

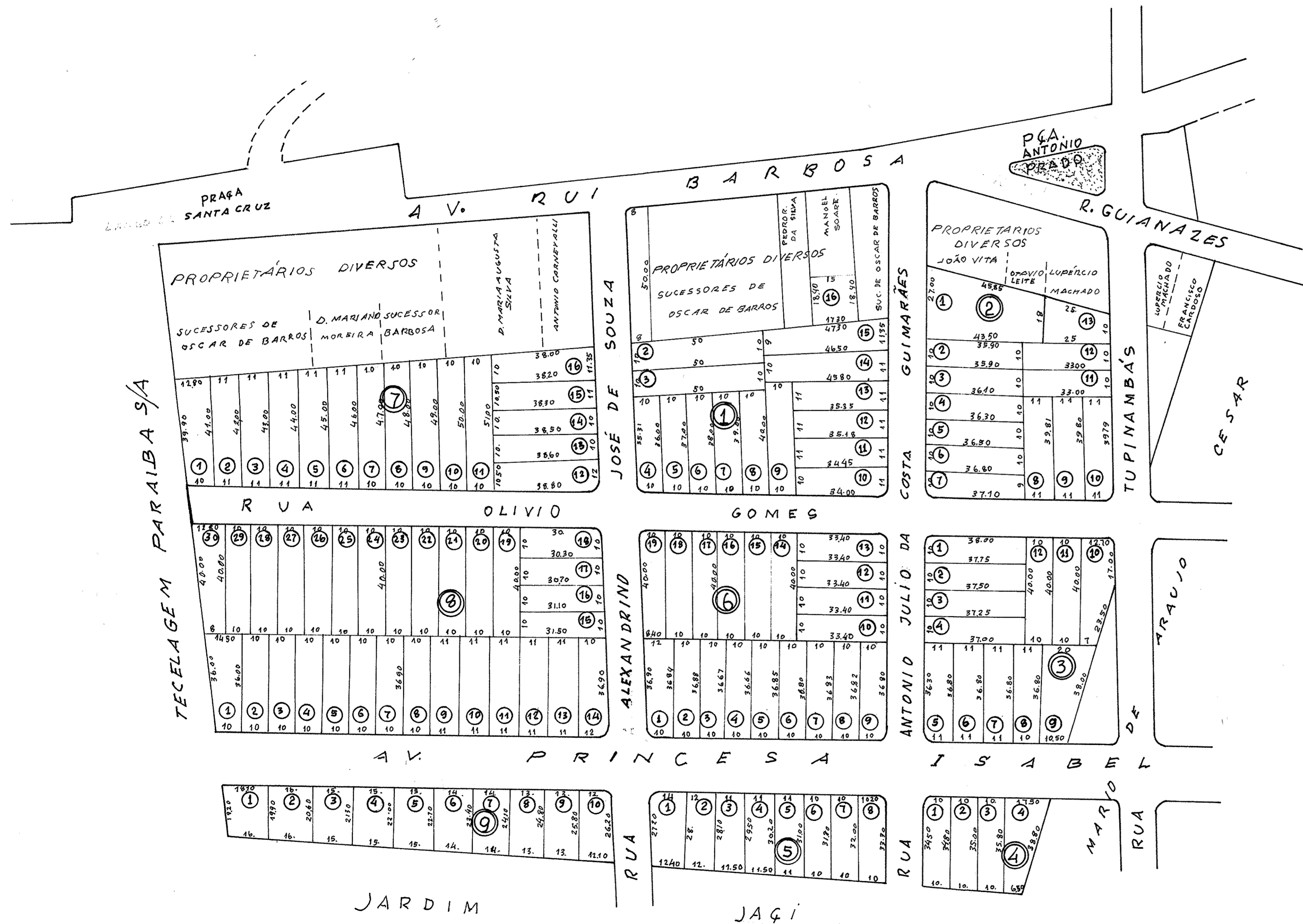

RELAÇÃO DAS QUADRAS =										
1	400.00	1	372.96	1	403.73	1	452.25	1	452.25	
2	550.00	2	376.15	2	368.85	2	369.00	2	369.00	
3	500.00	3	373.25	3	366.75	3	366.75	3	366.75	
4	357.00	4	371.25	4	368.65	4	369.00	4	369.00	
5	369.00	5	402.10	5	368.55	5	369.00	5	369.00	
6	379.00	6	404.60	6	368.48	6	369.00	6	369.00	
7	385.00	7	408.80	7	368.38	7	369.00	7	369.00	
8	395.00	8	396.20	8	368.25	8	369.00	8	369.00	
9	430.00	9	361.20	9	366.10	9	409.96	9	409.96	
10	357.36	10	485.20	10	334.00	10	455.55	10	455.55	
11	381.42	11	400.00	11	324.00	11	457.55	11	457.55	
12	386.37	12	400.00	12	334.00	12	405.90	12	405.90	
13	391.32	13	332.00	13	405.90	13	405.90	13	405.90	
14	468.25	14	400.00	14	400.00	14	403.40	14	403.40	
15	477.20	15	400.00	15	400.00	15	400.00	15	400.00	
16	311.10	16	400.00	16	400.00	16	400.00	16	400.00	
654,702		1,479,10		704,968		115,115				
1	974.00	1	343.50	1	460.36	1	353.95	1	353.95	
2	352.40	2	350.50	2	456.60	2	324.00	2	324.00	
3	360.00	3	353.50	3	467.50	3	314.25	3	314.25	
4	362.00	4	429.60	4	468.90	4	324.75	4	324.75	
5	364.00	1	340.20	1	478.50	5	335.2	5	335.2	
6	366.50	2	327.37	2	479.50	6	322.70	6	322.70	
7	346.85	3	335.71	3	489.50	7	332.50	7	332.50	
8	431.78	4	334.60	4	500.80	8	317.85	8	317.85	
9	435.95	5	314.00	5	508.00	9	126.95	9	126.95	
10	434.15	6	310.50	6	475.00	10		10		
11	330.00	7	321.50	7	485.00	11		11		
12	330.00	8	330.29	8	495.00	12		12		
13	341.00			9	508.00	13		13		
14	467.50			10	508.00	14		14		
590,90		2,667,99		7,271,06						
RESUMO										
AREA DAS QUADRAS										
Nº	1	6,547,02								
2	5,901,90									
3	4,909,21									
4	1,479,10									
5	2,667,99									
6	7,049,69									
7	7,271,06									
8	11,513,13									
9	3,261,60									
AREA DAS DUAS AVENIDAS										
RUA	A	6,291,00								
B	1,075,50									
C	2,716,85									
D	2,829,45									
		4,844,90								17,817,70
AREA TOTAL		68,418,41								