

PLANTA DA

VILA NOVA GUARANI (PARTE)

SÃO JOSÉ DOS CAMPOS

ESCALA 11000

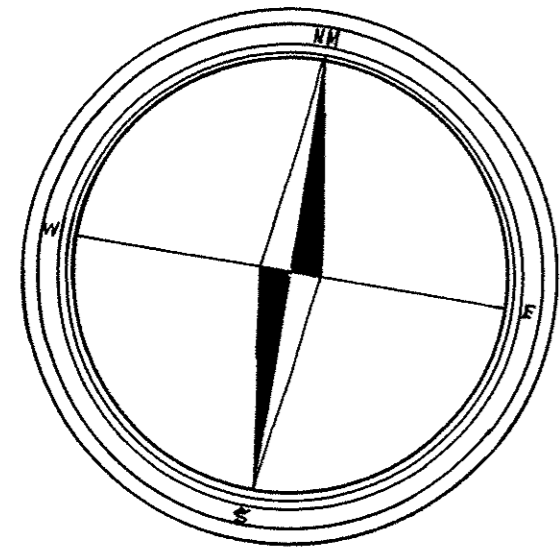

EIXO DO NOVO LEITO DA ESTRADA DE FERRO CENTRAL DO BRASIL

FAIXA "NON AEDIFICANDI"

NOVO LEITO DA ESTRADA DE FERRO CENTRAL DO BRASIL

VIELA EXISTENTE (antiga rua AIMORE)

RIBEIRÃO LAVAPES

AREA DE AZEVEDO

AREA DE LUIZ GONZAGA

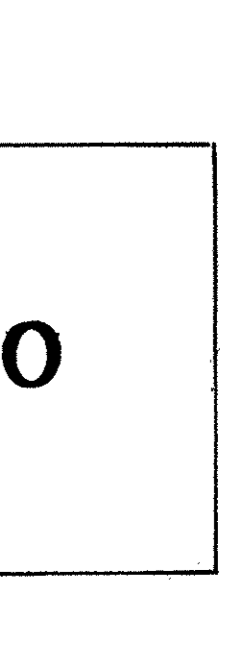
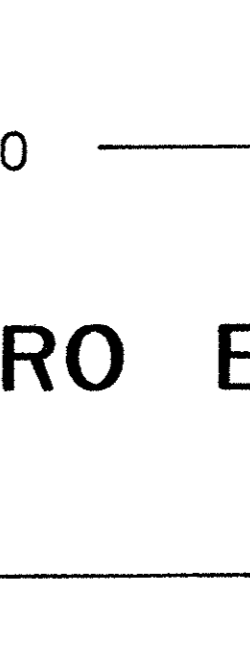
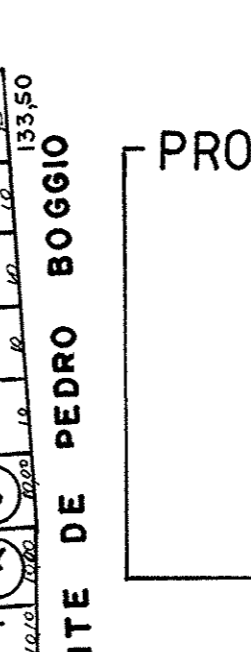
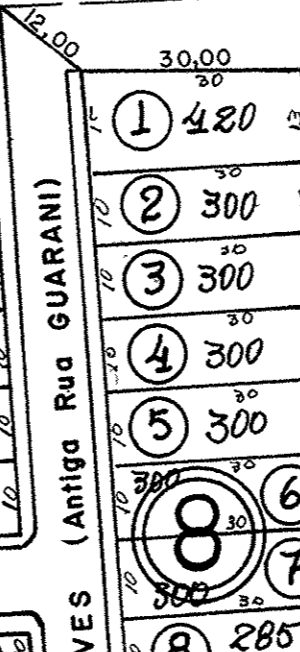
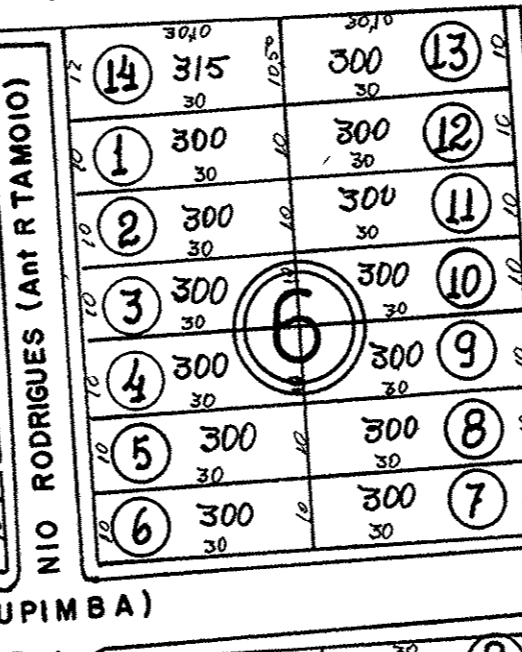
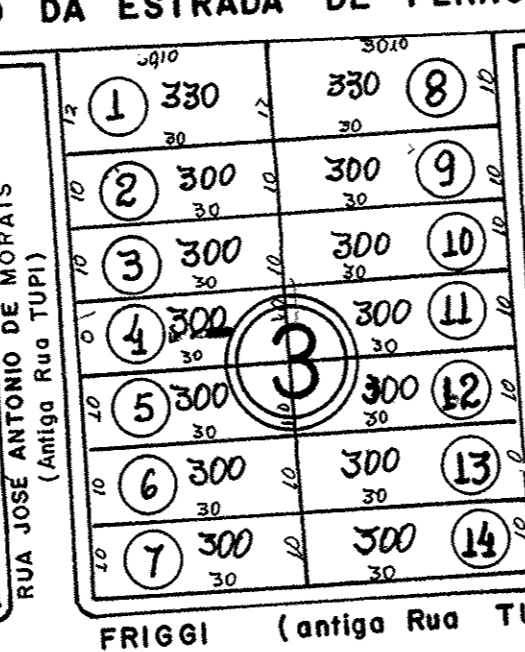
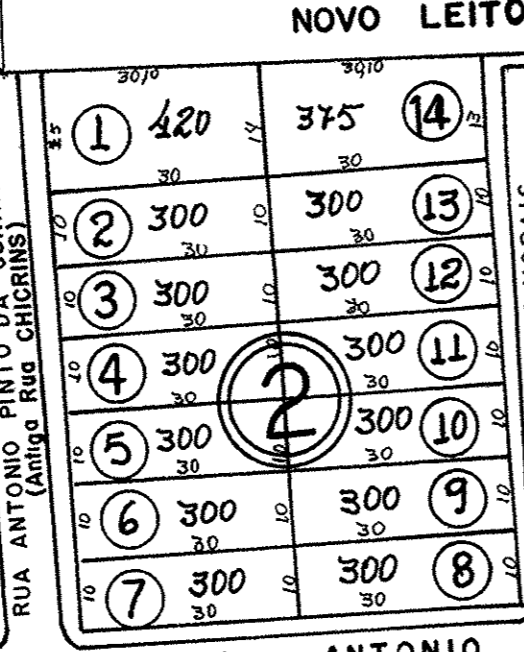
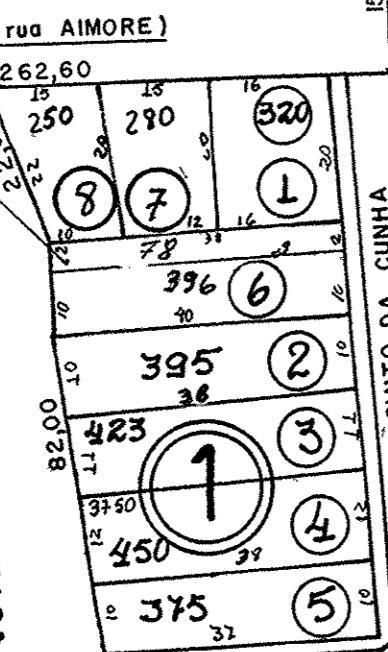

PROPRIETÁRIO
PEDRO BOGGIO

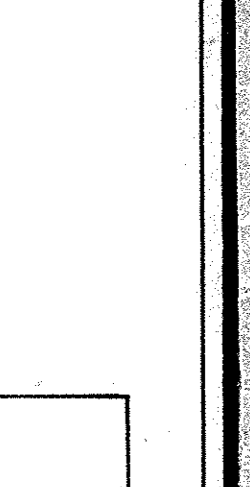
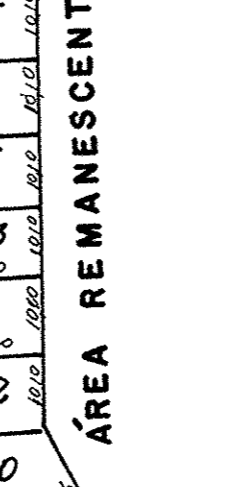
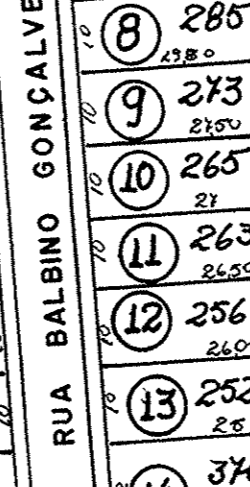
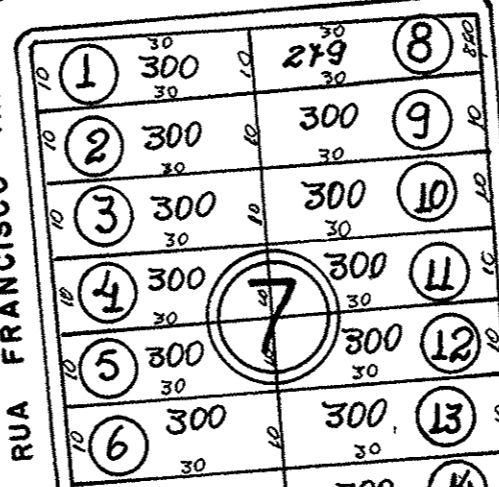
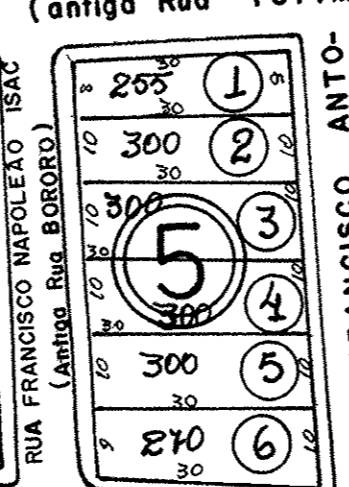
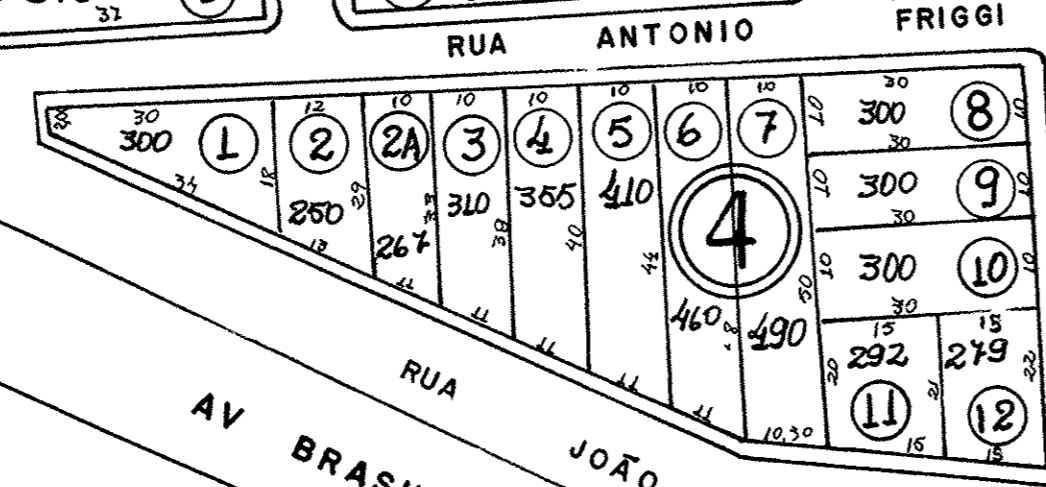

ÁREAS

| | |
|--------------|----------------------------|
| LOTES | 35.709 |
| RUAS | 13.300 |
| TOTAL | 49.009m² |

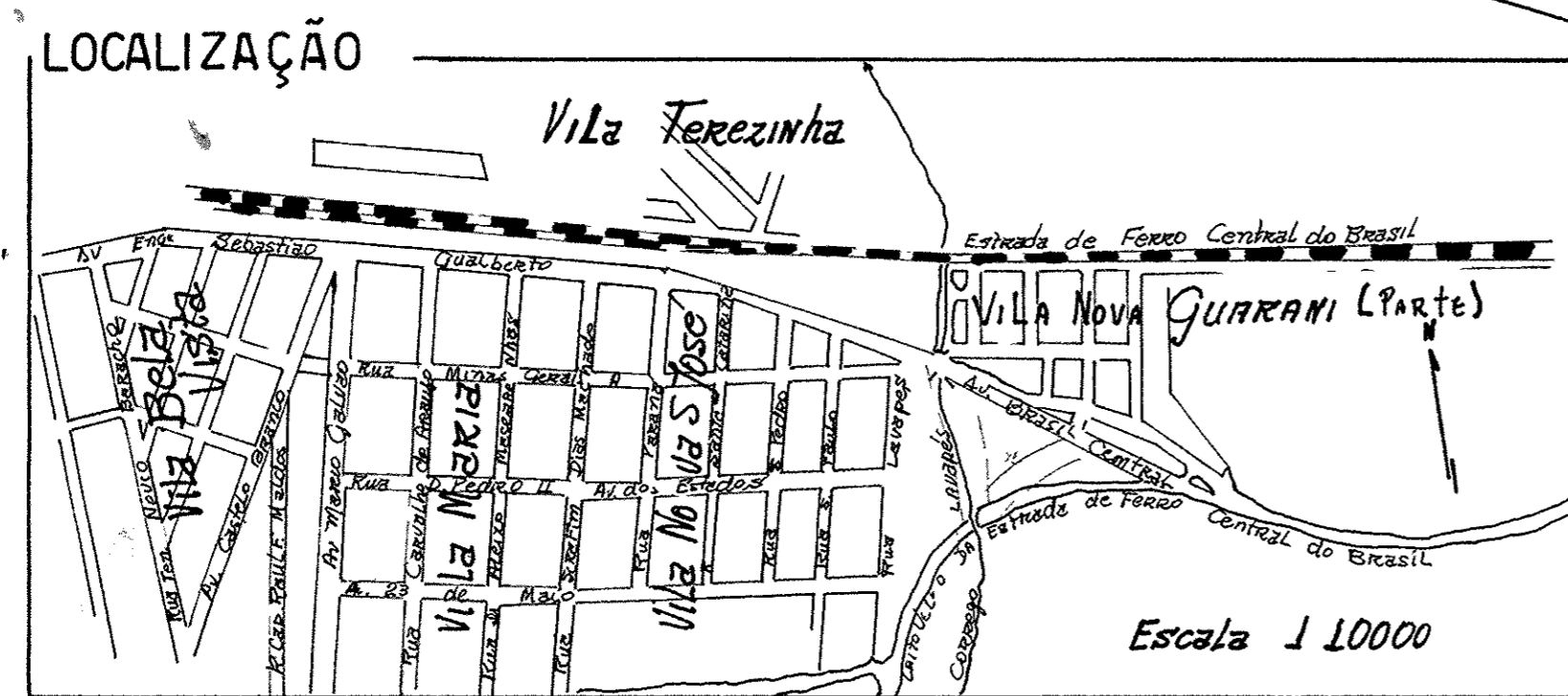

Prefeitura Estância de São José dos Campos
Depto de Obras
Desenho Luiz Takamura - Esc. 1/1000
VISTO

DIRETOR PREFEITO